

ME 1403 Engineering Practice & Graphics

Lecture 15

Chapter-12

Instructor:

Syed Hasib Akhter Faruqui

[Email: shafnehal@gmail.com](mailto:shafnehal@gmail.com)

Announcement!

Midterm (Next Week!!)

Syllabus:

- Chapter 5,
 - Chapter 6,
 - Chapter 7,
 - Chapter 8,
 - Chapter 9.
-
- **Note:** Practice all the tools shown in the class. In Midterm, you will be asked to use some of the tools specifically. If you are not using those tools points will be taken off.

Outline

- Concept
 - Assembly Modeling
 - Bottom-up Assembly
 - Top-down Assembly
- Tools / Methods (Check the zip file uploaded on Website/Blackboard)
 - Importing Part
 - Creating Assemblies
 - Mates
 - Exploded View
 - Assembly Editing (Feature Editing)
- Practice
 - Tutorial 1 (Will be Graded)

Assembly Submission Rules

- Put all your assembly file in a single folder. If you are not placing all the files at a single place, the assembly file won't open.
- Create a zip file and submit the zip file on blackboard. If you don't know how to create one please check the following videos:
 - For Windows: <https://www.youtube.com/watch?v=hvllEkxJPrU>
 - For MAC: <https://www.youtube.com/watch?v=V0wkG6zOpjA>
 - For linux: <https://www.youtube.com/watch?v=7RHGb0bxyGA>
- If you are not submitting all the part files, points will be deducted!

Tutorial 1(Will be Graded)

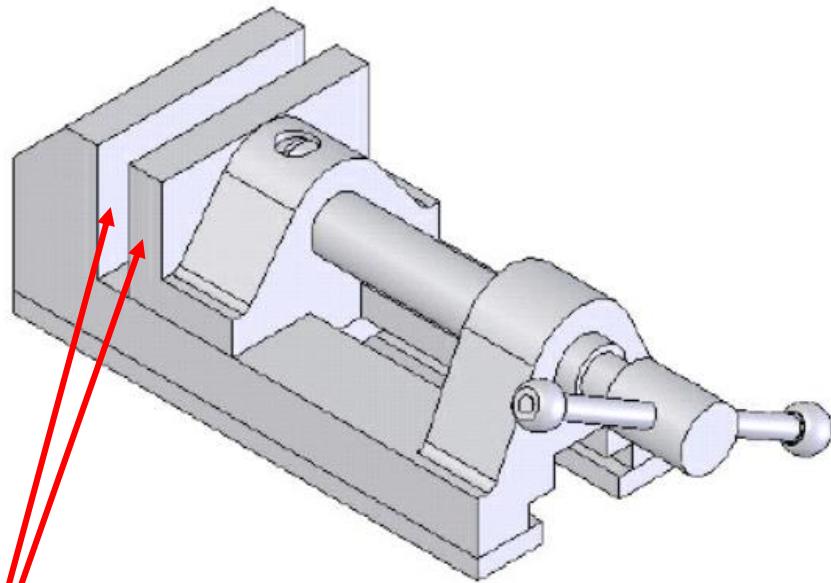

Movable Advance
Mate Applied

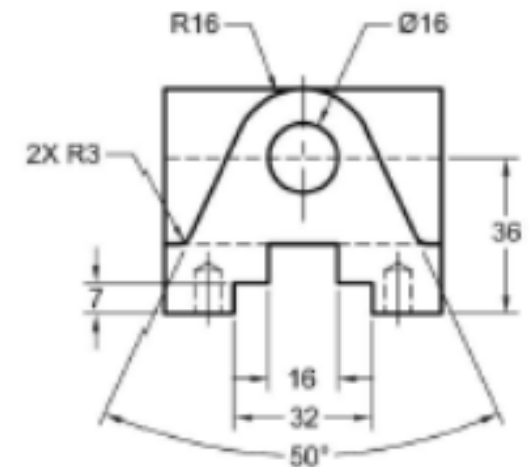
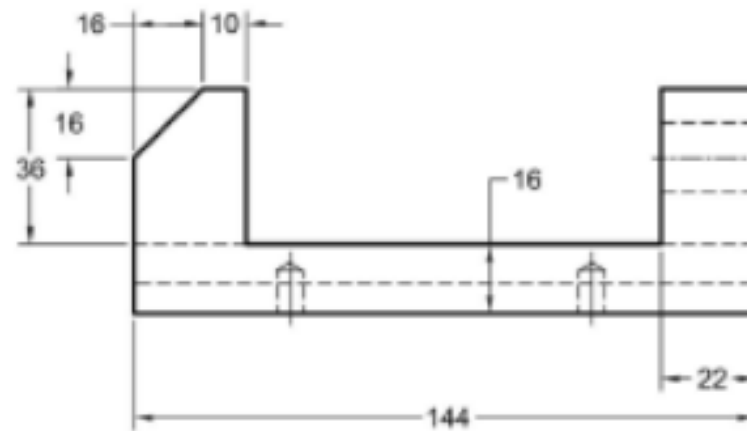
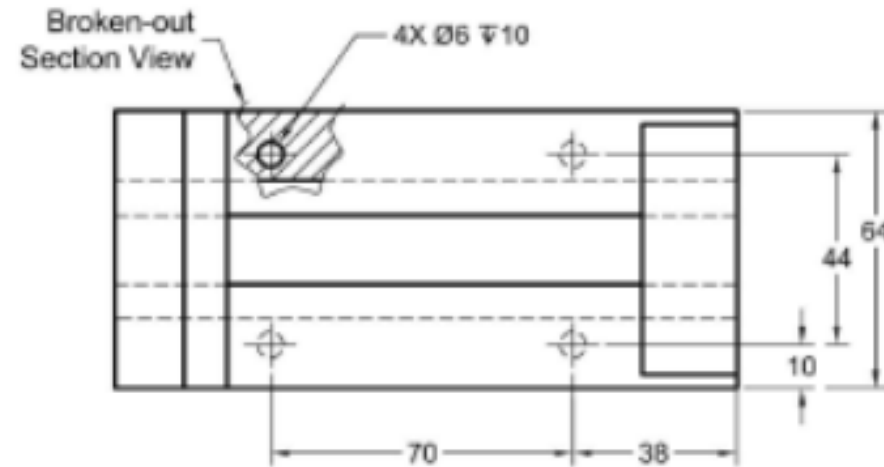

File Name: Your_Section_Your_ID_Ch12Tut1

Tutorial 1(Will be Graded)

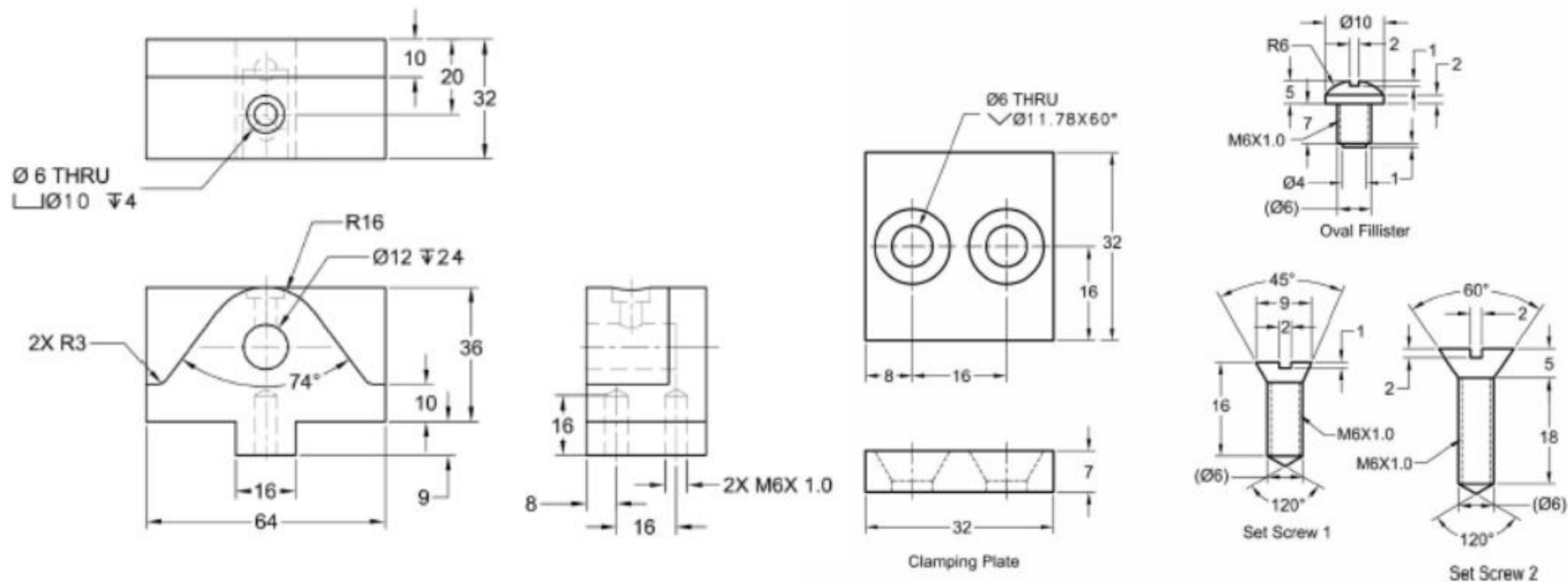

File Name: Your_Section_Your_ID_Ch12Tut1

Tutorial 1(Will be Graded)

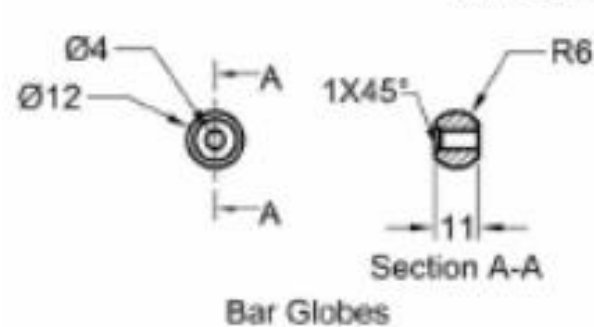
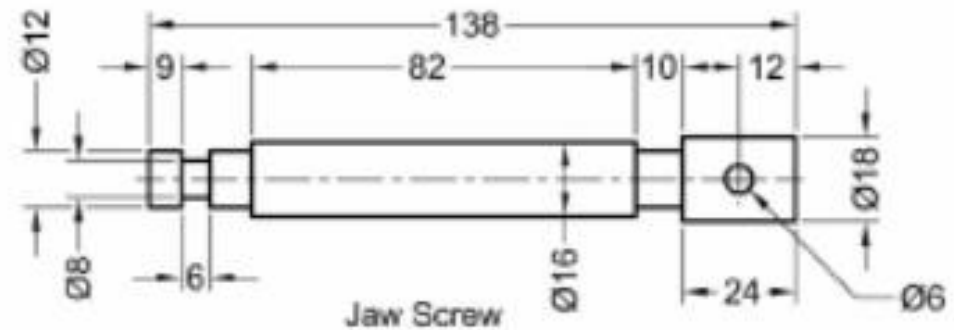
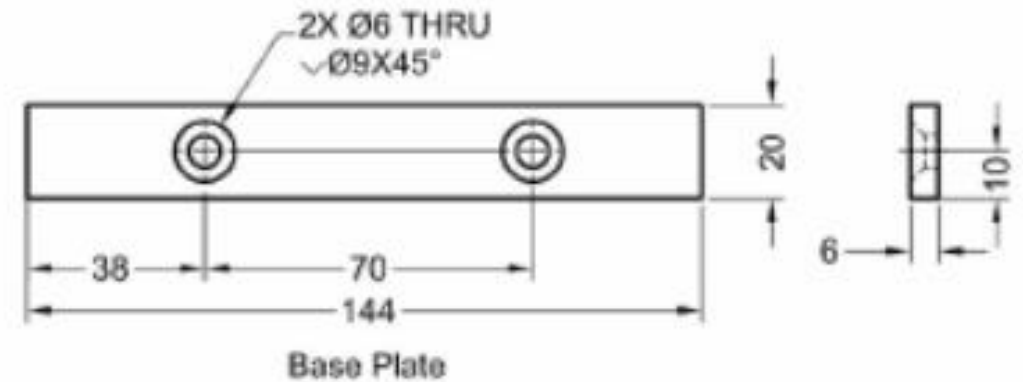

Submission Rules

- Homework's are due **at the Sunday 11.59 P.M.** of the following week (*More Discussion on next class*).
- Quiz's will be taken.
- Submit everything via **Blackboard**.
- Copying your assignments are **prohibited**. If you do so, you and the individual you copied from will receive a **grade zero**, plus both of you will be referred for actions as described in the university's policy for academic dishonesty. ([Read Section 203 of the Student Code of Conduct 2013-2013 UTSA Information Bulletin.](#))