

ME 1403 Engineering Practice & Graphics

Lecture 12

Chapter-7

Instructor:

Syed Hasib Akhter Faruqui

[Email: shafnehal@gmail.com](mailto:shafnehal@gmail.com)

Outline

- Tools / Methods
 - Swept Boss / Swept Cut
 - Rib Feature
 - Translate/ Rotate/ Copy
- Practice
 - Exercise 1 (**Will be Graded**)

Exercise 1(Will be Graded)

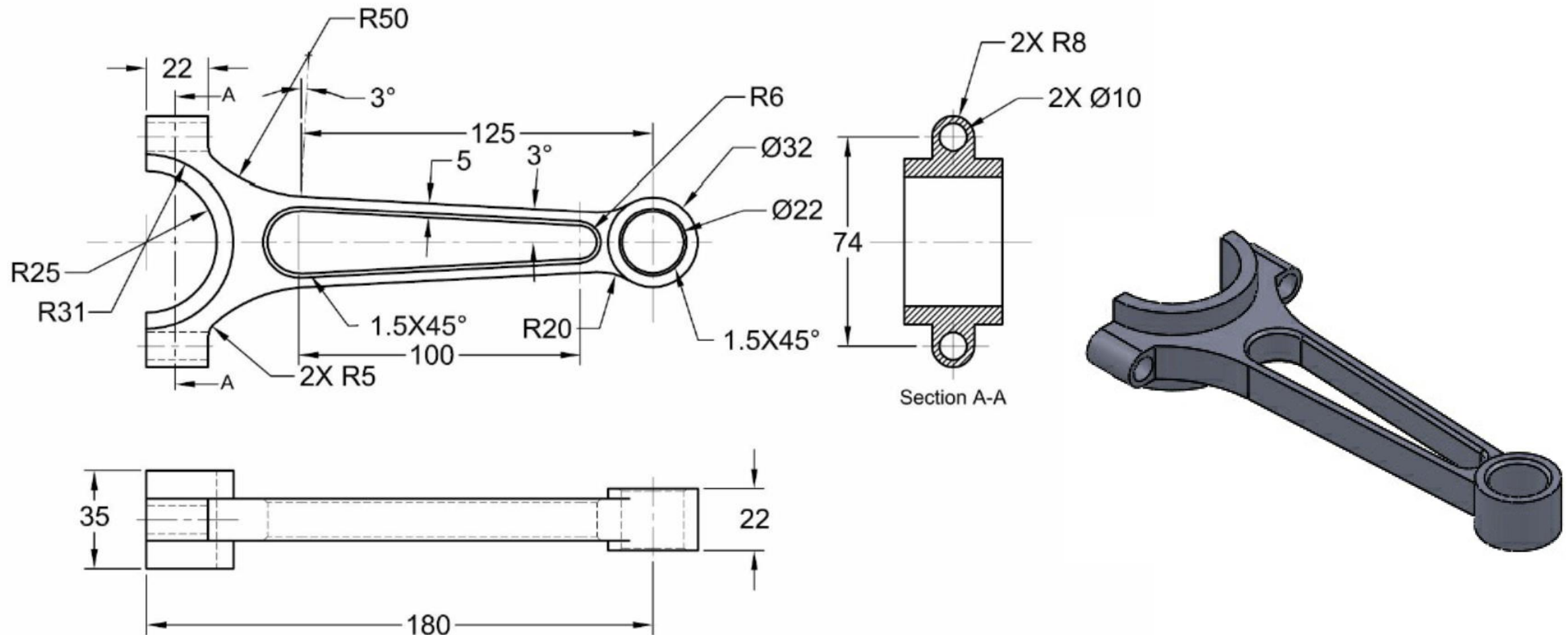

File Name: Your Section_Your ID_Ch7Ex1

Submission Rules

- Homework's are due **at the Sunday 11.59 P.M.** of the following week.
- Quiz's will be taken
- Submit everything via **Blackboard**.
- Copying your assignments are **prohibited**. If you do so, you and the individual you copied from will receive a **grade zero**, plus both of you will be referred for actions as described in the university's policy for academic dishonesty. ([Read Section 203 of the Student Code of Conduct 2013-2013 UTSA Information Bulletin.](#))